

**Lumens<sup>®</sup>**

# VC-TR1

Auto-Tracking PTZ Camera



# The PTZ Camera That Tracks It All

Automate live and on-demand video production and streaming for lecture capture, corporate training, house of worship and presentations.

## Intelligent Auto Tracking Mode

### Stage Tracking

Focuses on a presenter standing on a stage or behind a lectern and tracks the speaker's movement across the stage area.

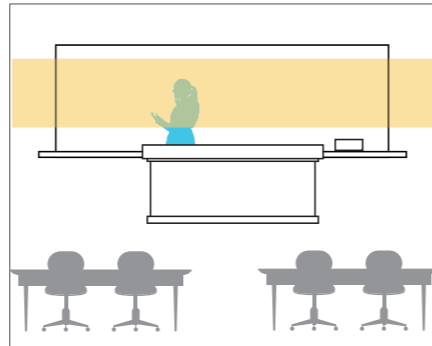

### Everywhere Tracking

With this mode, the camera will follow the speaker even if they leave the stage to interact with the audience. The system will maintain the tracking even if the speaker is obscured by other people.

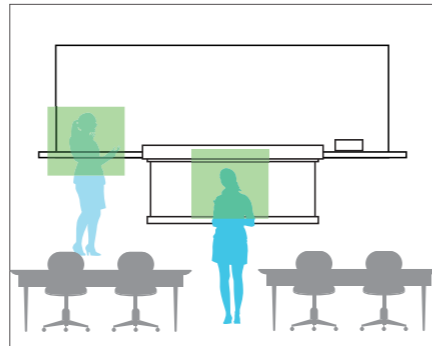

### Partition Tracking

Creates up to four preset zones to allow a presenter to move in a specific area. The camera will capture both the content on the display and the presenter.

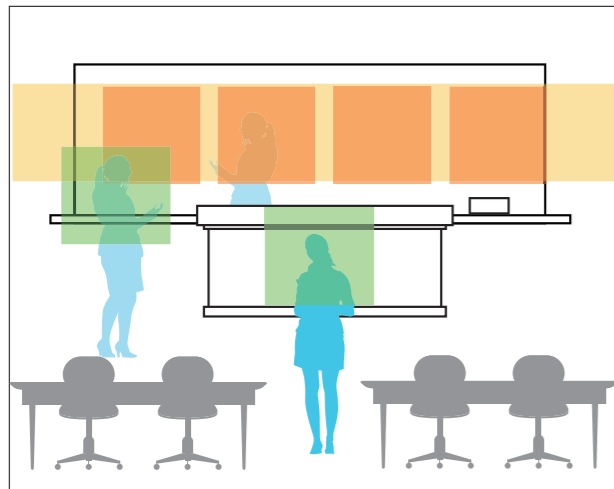
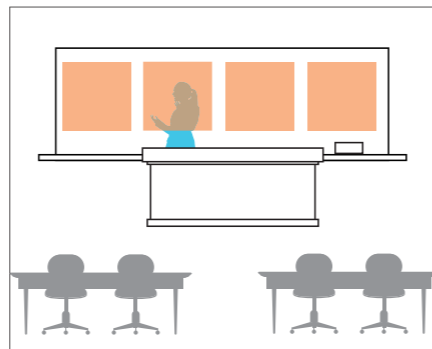

### Super Tracking

This mode intelligently combines all of the modes above, enabling the speaker to present formally or interact with panelists and the audience.

## Smart Self-Switching

The VC-TR1 combines a PTZ camera and a fixed 112° panoramic camera. With this design, it can capture an entire view and track a speaker simultaneously. The device can switch instantly between the two cameras. Audiences see not only a presenter but also the content on a whiteboard or presentation material.



## Outstanding Video with 20x Optical Zoom

The lens of the VC-TR1 provides an incredible 20x optical zoom. It delivers brilliantly clear video, and exceptional optical accuracy at 1080p resolution.



## Easy Installation Solution

The VC-TR1 supports Power over Ethernet (PoE+) and IP streaming to simplify AV integration. No camera controller is required.



## Streaming & Recording

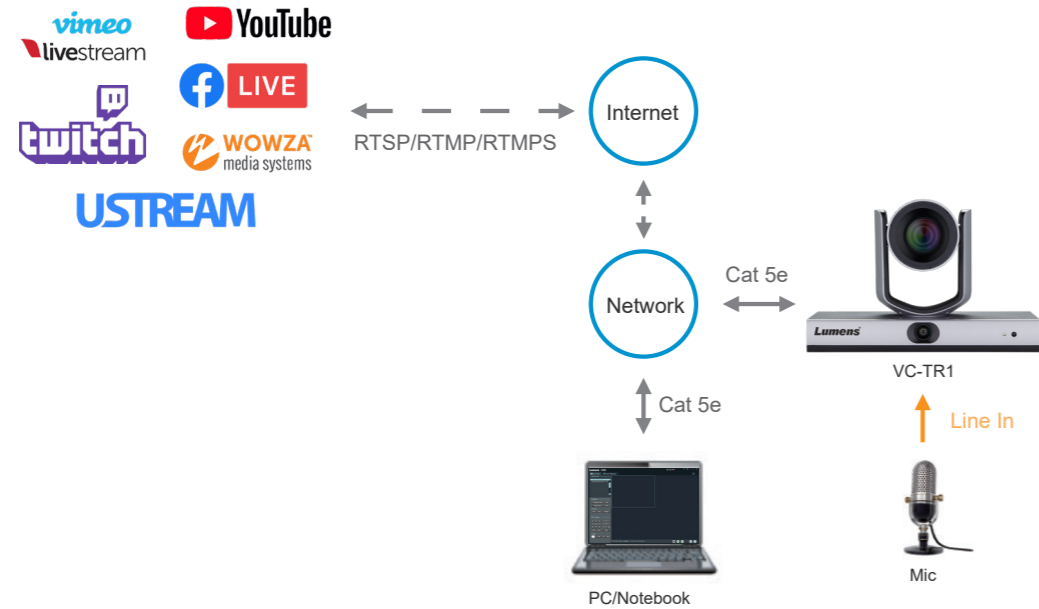

## Lecture Capture & Distance Learning

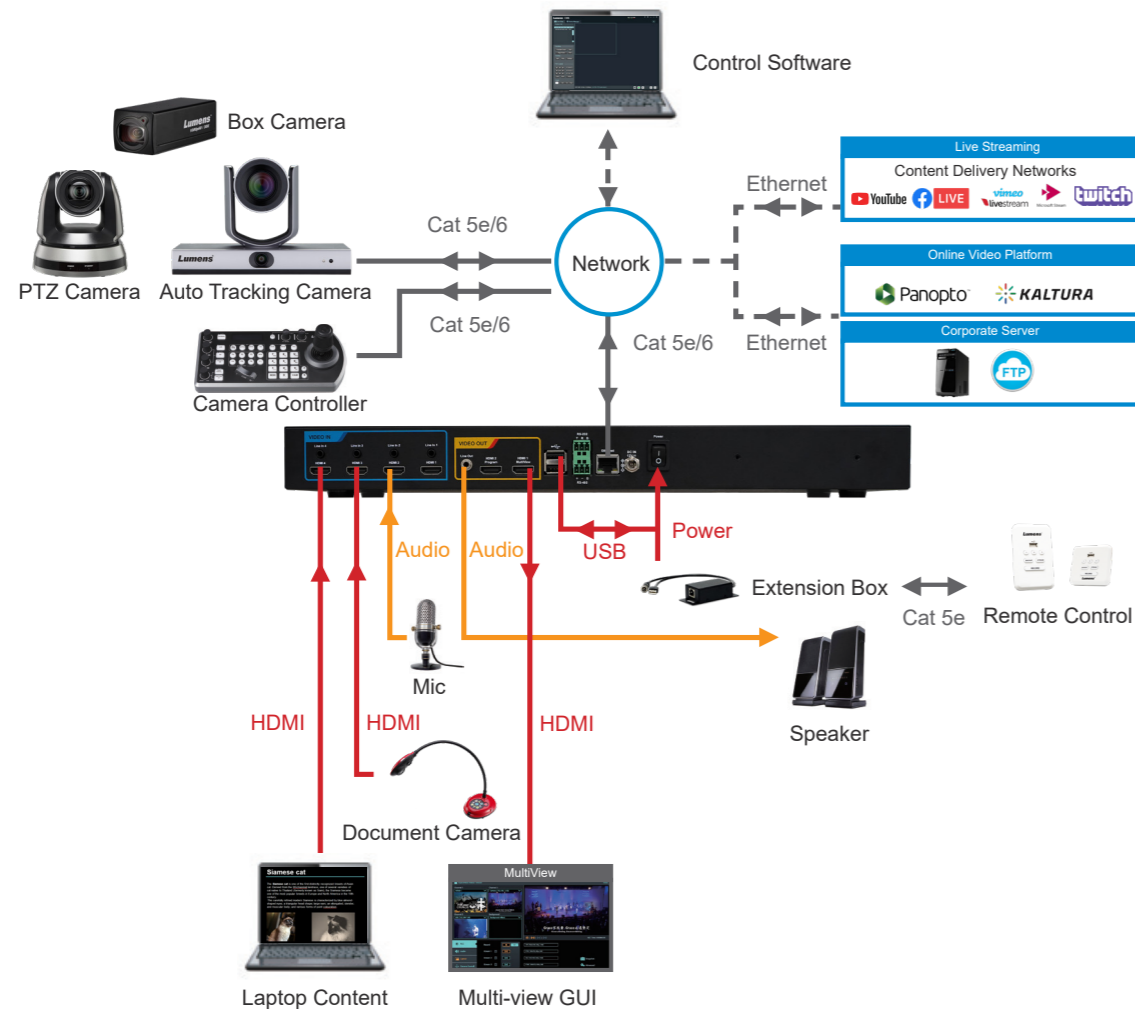

## Front panel



## Rear panel

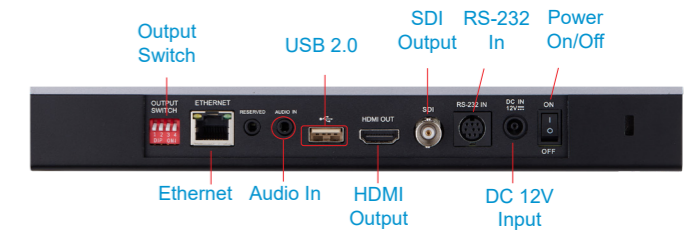

<b>Sensor</b>	PTZ Camera: 1/2.8" 2.13MP CMOS Panoramic Camera: 1/2.5" 8.57MP CMOS
<b>Video Format</b>	Resolution: 1080p / 720p Frame Rate : 60 / 50 / 30 / 25
<b>Video Output (HD) Interface</b>	HDMI / SDI / Ethernet or USB2.0
<b>Optical Zoom</b>	20x
<b>Digital Zoom</b>	12x
<b>PTZ Camera Viewing Angle</b>	58.7° (H) 45° (V) 71° (D)
<b>Panoramic Camera Viewing Angle</b>	100° (H) 80° (V) 112° (D)
<b>Panning Angle</b>	+90 ~ -90°
<b>Panning Speed</b>	100°/sec
<b>Tilting Angle</b>	+90 ~ -30°
<b>Tilting Speed</b>	80°/sec
<b>Auto-Tracking</b>	Yes
<b>Auto-Switching</b>	Yes
<b>Aperture</b>	F1.6 ~ F3.5
<b>Focal Length</b>	4.9mm ~ 94mm
<b>Shutter Speed</b>	1/60 ~ 1/10,000
<b>Minimum Object Distance</b>	500mm
<b>Video S/N Ratio</b>	> 40dB
<b>Minimum Illumination</b>	1.0Lux @ (F1.6, AGC ON)
<b>Focus System</b>	Auto / Manual
<b>Gain Control</b>	Auto / Manual

<b>White Balance</b>	Auto / Manual
<b>Exposure Control</b>	Auto / Manual
<b>WDR</b>	Yes
<b>2D NR</b>	Yes
<b>3D NR</b>	Yes
<b>Preset Positions</b>	256
<b>Multiple Video Stream</b>	1 x PTZ Camera Main Stream 1 x Panoramic Camera Main Stream 1 x PTZ Camera Sub Stream
<b>Audio Compression Format</b>	AAC
<b>Control Interface</b>	RS-232 / Ethernet
<b>Control Protocol</b>	VISCA / VISCA over IP
<b>PoE</b>	PoE+ (IEEE802.3at)
<b>Video Stream</b>	RTSP / RTMP / RTMPS
<b>Video Compression</b>	HEVC(H.265) / H.264 / MJPEG
<b>Audio Input</b>	Line In, Phone Jack 3.5mm x1
<b>Audio Output</b>	Ethernet / USB
<b>IR Receiver</b>	Yes
<b>IR Remote Control</b>	Yes
<b>DC In</b>	12V
<b>Power Consumption</b>	PoE: 17W DC In: 16W
<b>Weight</b>	3.1lbs (1.4 kg)
<b>Dimensions</b>	9.6" x 5.7" x 6.5" (245 x 145 x 165 mm)